

85,000 SF INDUSTRIAL • PALMER INDUSTRIAL PARK 1 THIRD STREET, PALMER, MA



DESCRIPTION

Up to 85,000 sf of industrial space in the Palmer Industrial Park. This building is ideal for manufacturing or distribution and is only minutes from the MA Pike.

LOCATION

1 Third Street, Palmer MA, only minutes from the MA Pike, and close to all of New England.

FEATURES

- 85,000 square feet divisible at 26,000 SF
- Ideal for manufacturing/distribution
- Ample docks and drive-in doors
- Clean, secure, modern building
- 1200 amp 3-phase electrical
- Located in Palmer Industrial Park
- Minutes from MA Pike Exit 8
- Easy access to all of New England



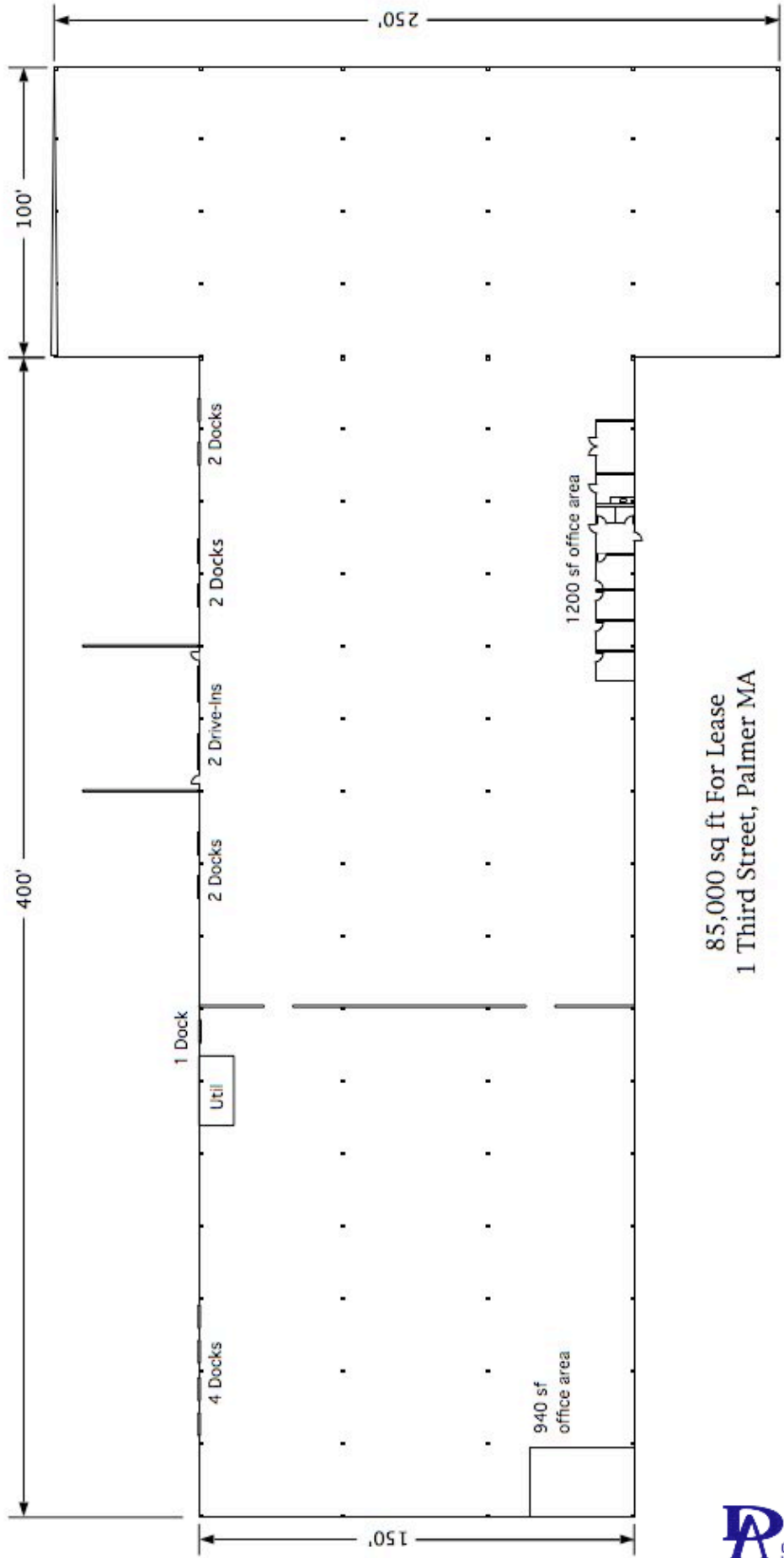

85,000 sq ft For Lease
 1 Third Street, Palmer MA

DEVELOPMENT ASSOCIATES

Brokers / Developers / Managers
 of Commercial Properties

(413) 789-3720 • www.DevAssociates.com